

# KITTTITAS COUNTY COMMUNITY DEVELOPMENT SERVICES

411 N. Ruby St., Suite 2, Ellensburg, WA 98926

CDS@CO.KITTTITAS.WA.US

Office (509) 962-7506

Fax (509) 962-7682

SD-08-00001

## SHORELINE SUBSTANTIAL DEVELOPMENT/ CONDITIONAL USE PERMIT APPLICATION

*(Proposing a project greater than \$5,000 value within 200 feet of a body of water listed below)*

### Associated Bodies of Water:

Little Creek	Lake Keechelus	Lake Kachess
Cabin Creek	Lake Cle Elum	Lake Easton
Log Creek	Lost Lake	Cle Elum River
Swauk Creek	Unnamed Lakes (T21,R12)	Columbia River
Wilson Creek (S. of Ellensburg)	Tucquala Lake	Yakima River
Naneum Creek	Cooper Lake	Kachess River
Taneum Creek	Manastash Lake	Teanaway River (Includes:
Manastash Creek (Includes S. Fork)		West, Middle, North Forks)
Big Creek		

KITTTITAS COUNTY ENCOURAGES THE USE OF PRE-APPLICATION MEETINGS. PLEASE CONTACT COMMUNITY DEVELOPMENT SERVICES TO SET UP A PRE-APPLICATION MEETING TO DISCUSS A PROPOSED PROJECT.

PLEASE TYPE OR PRINT CLEARLY IN INK. ATTACH ADDITIONAL SHEETS AS NECESSARY. PURSUANT TO KCC 15A.03.030, A COMPLETE APPLICATION IS DETERMINED WITHIN 28 DAYS OF RECEIPT OF THE APPLICATION SUBMITTAL PACKET AND FEE. THE FOLLOWING ITEMS MUST BE ATTACHED TO THE APPLICATION PACKET:

### REQUIRED ATTACHMENTS

- ADDRESS LIST OF ALL LANDOWNERS WITHIN 500 FEET OF THE SUBJECT PARCEL(S). IF ADJOINING PARCELS ARE OWNED BY THE APPLICANT, THEN THE 500 FOOT AREA SHALL EXTEND FROM THE FARTHEST PARCEL. IF THE PARCEL IS WITHIN A SUBDIVISION WITH A HOMEOWNERS' OR ROAD ASSOCIATION, THEN PLEASE INCLUDE THE MAILING ADDRESS OF THE ASSOCIATION.
- SITE PLAN OF THE PROPERTY WITH ALL PROPOSED BUILDINGS, POINTS OF ACCESS, ROADS, PARKING AREAS, SEPTIC TANK, DRAINFIELD, DRAINFIELD REPLACEMENT AREA, AREAS TO BE CUT AND/OR FILLED, NATURAL FEATURES SUCH AS CONTOURS, STREAMS, GULLIES, CLIFFS, ETC.
- SEPA CHECKLIST REQUIRED D N S
- FLOOD PERMIT APPLICATION IF WITHIN 100 YEAR FLOODPLAIN
- PROJECT DIAGRAMS WITH SCALE:
  - SITE PLAN (s):
    - VICINITY MAP, SITE LOCATION USING NATURAL POINTS OF REFERENCE (INCLUDE NAME OF WATER BODY)
    - SITE BOUNDARY
    - PROPERTY DIMENSIONS IN VICINITY OF PROJECT
    - ORDINARY HIGH WATER MARK (OHWM)
    - TYPICAL CROSS SECTION (s) SHOWING:
      - EXISTING GROUND ELEVATIONS
      - PROPOSED GROUND ELEVATIONS
      - HEIGHT OF EXISTING STRUCTURES
      - HEIGHT OF PROPOSED STRUCTURES

RECEIVED

JUL 21 2008

Kittitas County  
CDS

DARRYL PIERCY, DIRECTOR

ALLISON KIMBALL, ASSISTANT DIRECTOR

COMMUNITY PLANNING • BUILDING INSPECTION • PLAN REVIEW • ADMINISTRATION • PERMIT SERVICES • CODE ENFORCEMENT • FIRE INVESTIGATION

- PROPOSED LAND CONTOURS, 5' INTERVALS IN WATER, 10' LANDWARD OF OHWM
- DIMENSIONS AND LOCATIONS OF EXISTING STRUCTURES TO BE MAINTAINED
- DIMENSIONS AND LOCATIONS OF PROPOSED STRUCTURES
- SOURCE, COMPOSITION, AND VOLUME OF FILL MATERIAL
- COMPOSITION, VOLUME OF EXTRACTED MATERIALS AND PROPOSED DISPOSAL AREA
- LOCATION OF PROPOSED UTILITIES
- SEPTIC TANK COMPLIANCE WITH LOCAL AND STATE REGULATIONS

**APPLICATION FEE:**

\$1,400.00 (\$1,000 fee + \$400 SEPA) payable to Kittitas County Community Development Services (KCCDS)

**FOR STAFF USE ONLY**

APPLICATION RECEIVED BY:  
(CDS STAFF SIGNATURE)

DATE:

RECEIPT #

*Juan M. Sweeney*

7.21.08

**PAID**  
**DATE STAMP**  
**HERE 2008**  
**KITTITAS CO**  
**CDS**

NOTES:

**1. Name, mailing address and day phone of land owner(s) of record:**

*Landowner(s) signature(s) required on application form.*

Name: Washington Dept of Fish and Wildlife, Marty Peoples  
Mailing Address: 600 Capitol Way North  
City/State/Zip: Olympia, WA 98501  
Day Time Phone: 360-902-8426  
Email Address: peoplmdp@dfw.wa.gov

**2. Name, mailing address and day phone of authorized agent, if different from landowner of record:**

*If an authorized agent is indicated, then the authorized agent's signature is required for application submittal.*

Agent Name: \_\_\_\_\_  
Mailing Address: \_\_\_\_\_  
City/State/ZIP: \_\_\_\_\_  
Day Time Phone: \_\_\_\_\_  
Email Address: \_\_\_\_\_

**3. Street address of property:**

Address: Milepost 8, SR 821  
City/State/ZIP: Yakima, WA

**4. Legal description of property:**

Acres 12.43, CD. 9347-A; SEC. 22; TWP. 15; RGE. 19; TAX 3 E. OF YAKIMA RIVER (OUT OF TX 1)

**5. Tax Parcel Number:** 174133

**6. Property size:** 12.43 (acres)

**7. Narrative project description:** Please include the following information in your description: describe project size, location, water supply, sewage disposal and all qualitative features of the proposal; include every element of the proposal in the description (be specific, attach additional sheets as necessary):

See Attachment

8. Application is hereby made for permit(s) to authorize the activities described herein. I certify that I am familiar with the information contained in this application, and that to the best of my knowledge and belief such information is true, complete, and accurate. I further certify that I possess the authority to undertake the proposed activities. I hereby grant to the agencies to which this application is made, the right to enter the above-described location to inspect the proposed and or completed work.

All correspondence and notices will be mailed to the Land Owner of Record and copies sent to the authorized agent.

Signature of Authorized Agent:

(REQUIRED if indicated on application)

Marty Peoples

Date:

July 18, 2008

Signature of Land Owner of Record

(REQUIRED for application submittal):

Date:

## **WDFW Application for Shoreline Substantial Development Permit**

### *Yakima River Canyon Access Project Narrative*

WDFW currently owns and maintains a primitive access site on the Yakima River. This access site is located on the west side of SR 821 at milepost 8. This is two miles north of Roza Dam and directly across from Roza Road intersection with SR 821. This access site offers parking, river access, and small boat launching.

WDFW would like to upgrade this site to offer more opportunities and improve current functions. The specific components of this project are:

1. Pave the entrance to the access site to meet WSDOT guidelines.
2. Install a vault toilet and a paved parking pad next to the toilet to provide ADA parking and accessibility.
3. Grade and gravel access road and parking areas at this site, and place imported crushed aggregate on the parking area. Install barrier rock to control access.
4. Cut the top of the gravel bank at existing boat launch to attain a 15% grade.
5. Convert an informal dirt road on this site into a paved ADA accessible interpretive trail. This trail will be 5 feet wide.
6. Construct a 10' by 20' concrete wildlife viewing pad and an ADA accessible parking pad next to the viewing pad.
7. Install 4 strand smooth wire fence at Highway Right-of-Way.

Yakima River Canyon Access Site Project – List of Adjacent  
Property Owners

<i>Name of Adjacent Property Owners</i>	<i>Address</i>
---	----------------

<i>Randall Rice</i>	231 Roza View Drive Yakima, WA 98901
---------------------	---

<i>Phillup Mahre</i>	70 Roza View Dr Yakima, WA 98901
----------------------	-------------------------------------

<i>Bill Schurger</i>	915 Walla Walla Wenatchee, WA 98801
----------------------	--

<i>BNSF Railroad</i>	PO Box 961089 Fort Worth, Texas 76161-0089
----------------------	---

---

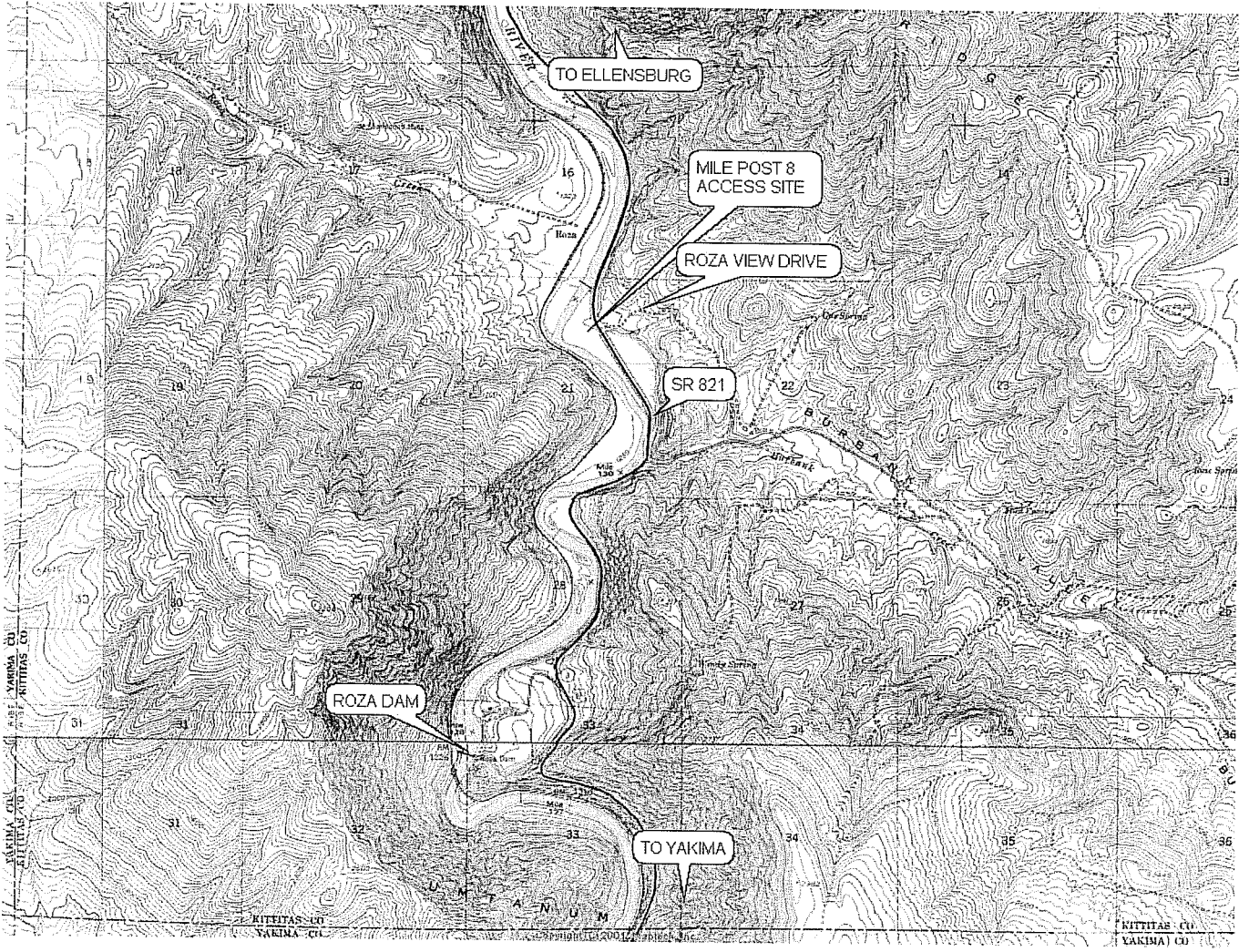

**VICINITY MAP**  
SCALE: NONE

PURPOSE: ACCESS SITE IMPROVEMENTS TOILET, PARKING, TRAILS, AND RIVER LAUNCH	WASHINGTON DEPT. of FISH & WILDLIFE 600 CAPITOL WAY N. OLYMPIA, WA 98501-1091	PROPOSED: MILEPOST 8 ROSA ROAD VICINITY MAP
DATUM: ASSUMED	REFERENCE NO. _____	IN: YAKIMA RIVER
ADJACENT PROPERTY OWNER: 1. _____ 2. _____	SITE: YAKIMA RIVER CANYON ACCESS	NEAR: ROZA COUNTY OF: KITTITAS STATE: WA
ENG. PROJECT NO. KS:A677:08-1	ADDRESS: SR 821 AT MILEPOST 8 YAKIMA, WA	PORTION OF: SEC. 21, T. 15N, R.19 E, W.M. DATE: 05/07/2008 SHEET 1 OF 7

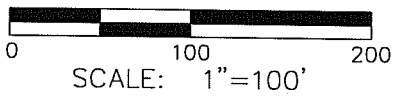
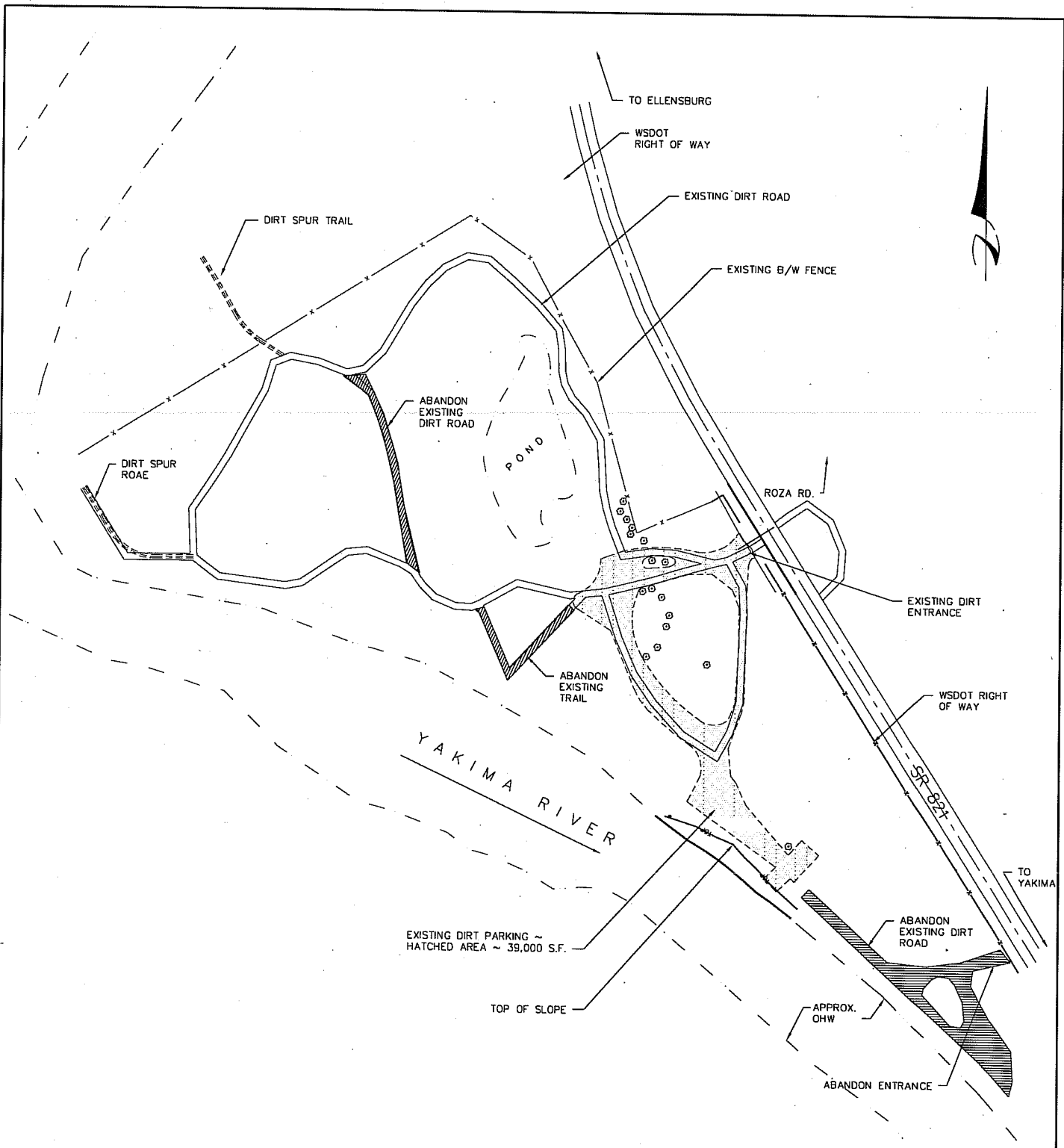

REFERENCE NO.	
APPLICANT:	WASHINGTON DEPT. of FISH & WILDLIFE
<b>YAKIMA RIVER CANYON ACCESS</b>	
EXISTING SITE PLAN	
AT:	YAKIMA RIVER, WASHINGTON
DATE:	5/7/2008 SHEET 2 OF 7



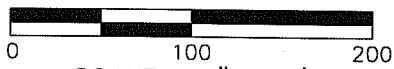
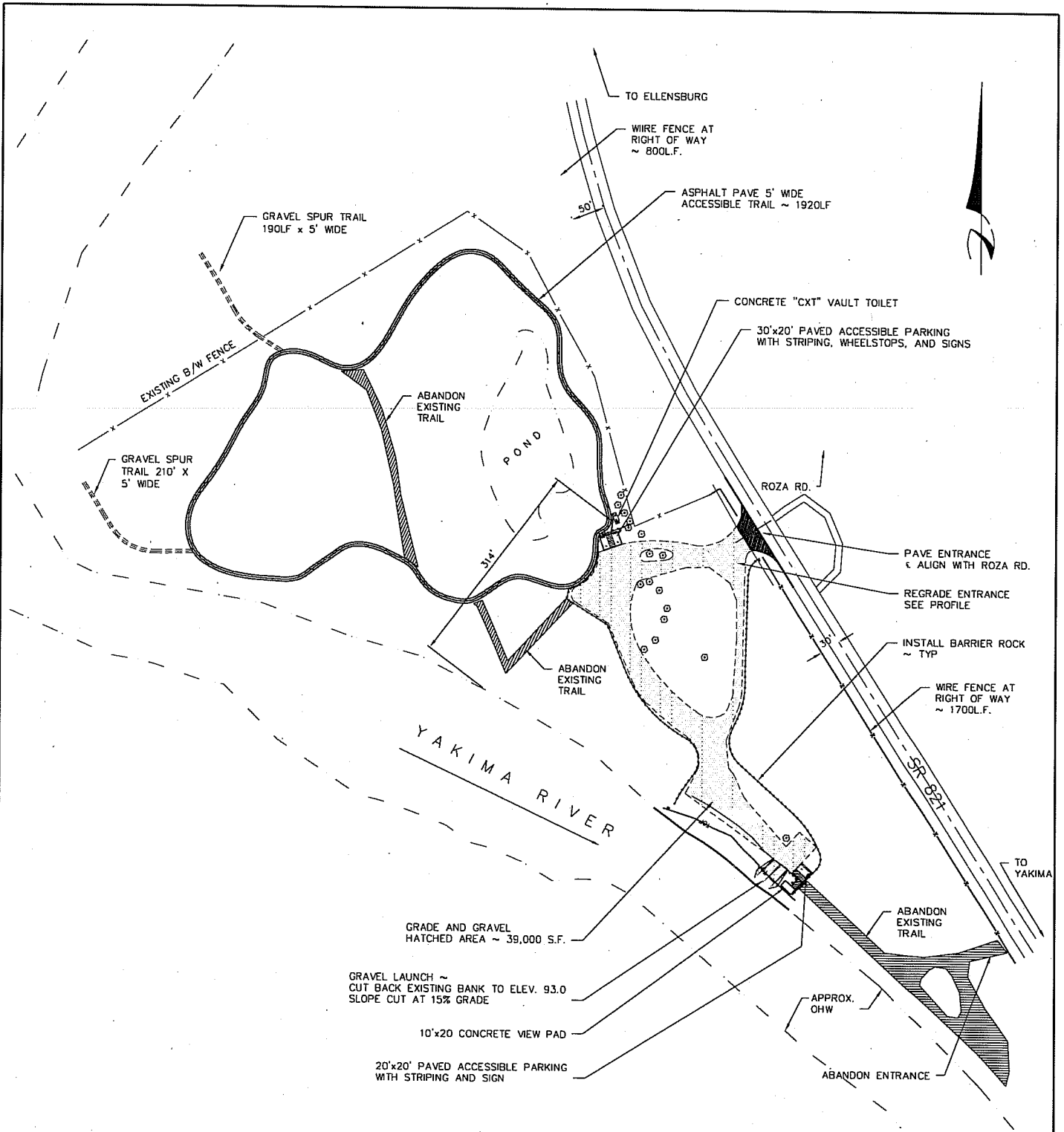

SCALE: 1"=100'

REFERENCE NO.	
APPLICANT:	WASHINGTON DEPT. of FISH & WILDLIFE
<b>YAKIMA RIVER CANYON ACCESS</b>	
SITE PLAN	
AT:	YAKIMA RIVER, WASHINGTON
DATE:	5/7/2008 SHEET 3 OF 7

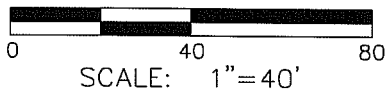
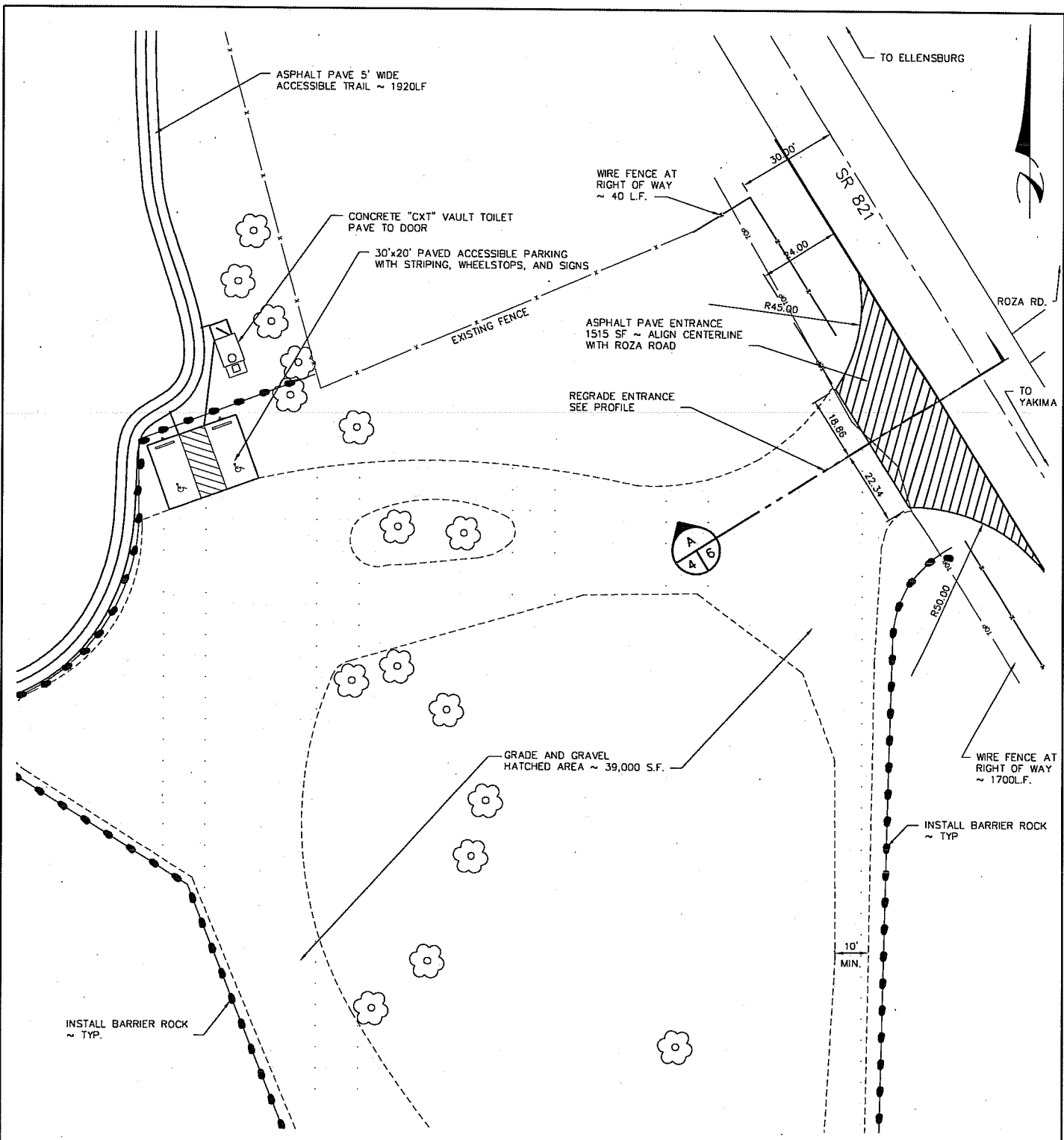

REFERENCE NO.
APPLICANT: WASHINGTON DEPT. of FISH & WILDLIFE
<b>YAKIMA RIVER CANYON ACCESS</b>
<b>ENTRANCE SITE PLAN</b>
AT: <u>YAKIMA RIVER</u> , WASHINGTON
DATE: <u>5/7/2008</u> SHEET <u>4</u> OF <u>7</u>

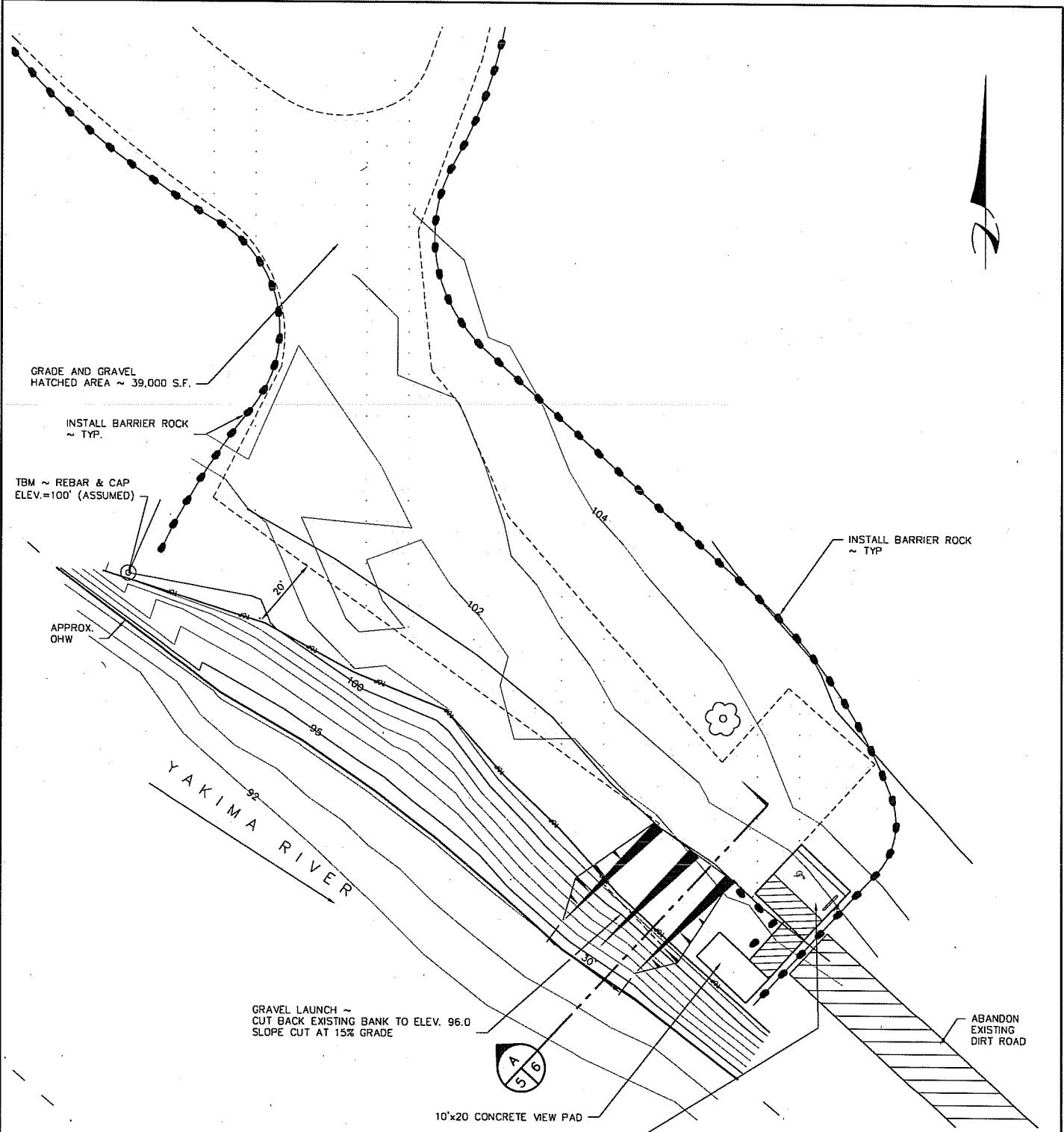

GRADE AND GRAVEL  
HATCHED AREA ~ 39,000 S.F.

INSTALL BARRIER ROCK  
~ TYP.

TBM ~ REBAR & CAP  
ELEV.=100' (ASSUMED)

INSTALL BARRIER ROCK  
~ TYP

APPROX.  
OHW

YAKIMA RIVER

GRAVEL LAUNCH ~  
CUT BACK EXISTING BANK TO ELEV. 96.0  
SLOPE CUT AT 15% GRADE

ABANDON  
EXISTING  
DIRT ROAD



10'x20 CONCRETE VIEW PAD

20'x20' PAVED ACCESSIBLE PARKING  
WITH STRIPING AND SIGN  
TOTAL PAVED AREA = 720 S.F.

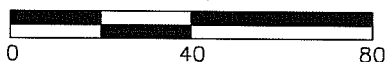

SCALE: 1"=40'

REFERENCE NO.
APPLICANT: WASHINGTON DEPT. of FISH & WILDLIFE
<b>YAKIMA RIVER CANYON ACCESS</b>
<b>LAUNCH SITE PLAN</b>
AT: <u>YAKIMA RIVER</u> , WASHINGTON
DATE: <u>5/7/2008</u> SHEET <u>5</u> OF <u>7</u>

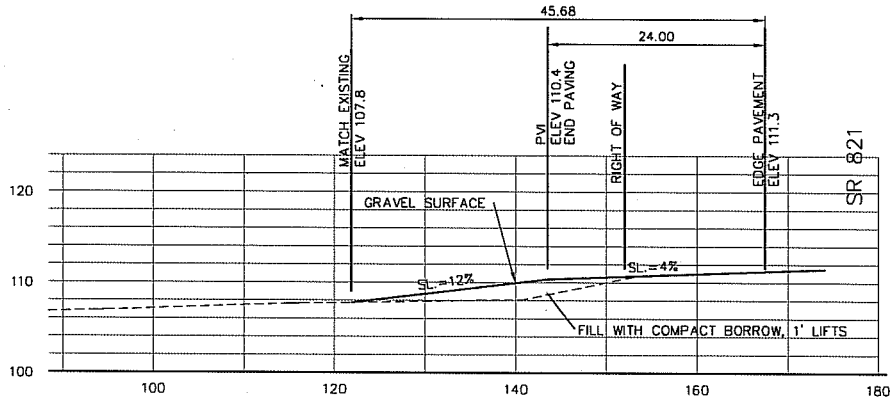

SECTION A  
SCALE: 1" = 20'

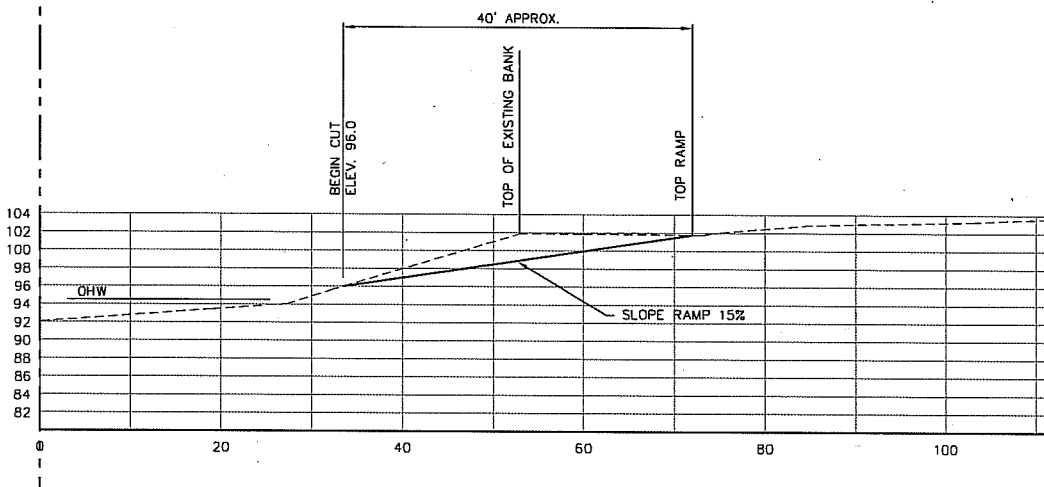

SECTION B  
SCALE: 1" = 20'

REFERENCE NO.	
APPLICANT:	WASHINGTON DEPT. of FISH & WILDLIFE
YAKIMA RIVER CANYON	
PROFILES	
AT:	WASHINGTON
DATE: 5/7/2008	SHEET 6 OF 7

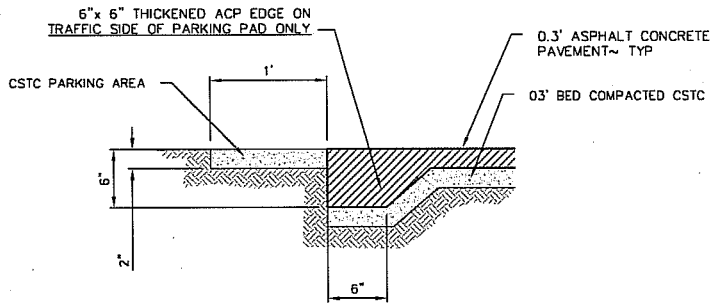

**THICKENED EDGE DETAIL**  
NOT TO SCALE

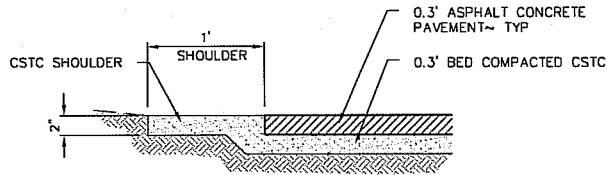

**TYPICAL PAVEMENT DETAIL**  
NOT TO SCALE

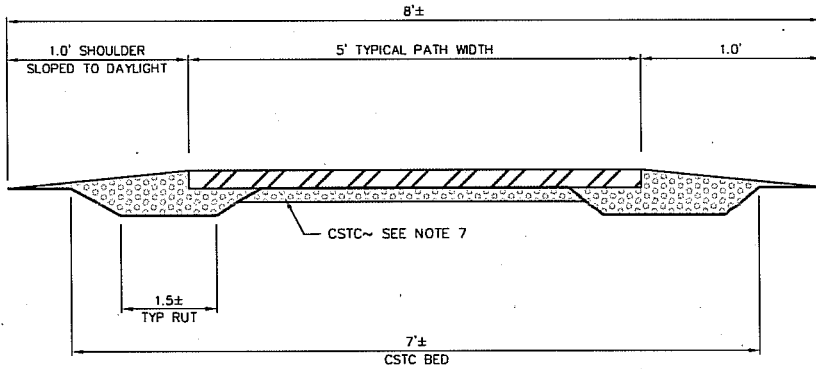

**TYPICAL PAVED TRAIL SECTION**  
NOT TO SCALE

REFERENCE NO.	
APPLICANT:	WASHINGTON DEPT. of FISH & WILDLIFE
	<b>YAKIMA RIVER CANYON</b>
	TYPICAL PAVEMENT SECTIONS
AT:	WASHINGTON
DATE:	5/7/2008 SHEET 7 OF 7



State of Washington

## DEPARTMENT OF FISH AND WILDLIFE

Mailing Address: 600 Capitol Way N - Olympia, Washington 98501-1091 - (360) 902-2200, TDD (360) 902-2207  
Main Office location: Natural Resources Building - 1111 Washington Street SE - Olympia, WA

### DETERMINATION OF NONSIGNIFICANCE (DNS)

**Name of Proposal:** YAKIMA CANYON ACCESS SITE

**Description of Proposal:**

This project includes the improvement of a primitive access site in the Yakima River Canyon near Roza Dam. The specific components of this project are:

1. Pave the entrance to the access site to meet WSDOT guidelines.
2. Install a vault toilet and a paved parking pad next to the toilet to provide ADA parking and accessibility.
3. Grade and gravel access road and parking areas at this site. Install barrier rock to control access.
4. Cut the top of the gravel bank at existing boat launch to attain a 15% grade.
5. Convert an informal dirt road on this site into a paved ADA accessible interpretive trail. This trail will be 5 feet wide.
6. Construct a 10' by 20' concrete wildlife viewing pad and an ADA accessible parking pad next to the viewing pad.
7. Install 4 strand smooth wire fence at Highway Right-of-Way.

**Proponent/Applicant:**

Washington Dept of Fish and Wildlife  
Capitol Programs & Engineering Division  
600 Capitol Way North  
Olympia, WA 98501-1091  
Contact Person: Marty Peoples  
Fish and Wildlife Biologist  
Telephone Number: (360) 902-8426  
Fax Number: (360) 902-8367  
E-Mail: peoplmdp@dfw.wa.gov

RECEIVED

JUL 21 2003

Kittitas County  
CDS

**Location of Proposal, including street, if any:** The Yakima River Canyon Access Site is located on the west side of SR 821 at milepost 8. This is two miles north of Roza Dam and directly across from Roza Road intersection with SR 821. The project site is in Kittitas County, Section 21, Township 15 North, Range 19 East. The parcel number is 174133.

**Lead Agency:** Washington Department of Fish and Wildlife (WDFW)

WDFW has determined that this proposal likely will not have a significant adverse impact on the

environment. Therefore, state law<sup>1</sup> does not require an environmental impact statement (EIS). WDFW made this determination of nonsignificance (DNS) after we reviewed the environmental checklist and other information on file with us. If you want to review this information, please contact WDFW at the address below.

Agencies, affected tribes, and members of the public are invited to comment on this proposal.

We issued this DNS according to state rules.<sup>2</sup> We will **not act on this proposal for 14 days** from the date we issued the DNS. If you have comments about this DNS or the proposal, you must send your comments to us so that we receive them within 14 days. This means we must receive your comments by **August 1, 2008**.

When you send us your comments, please provide the name of proposal in your comment letter, and mail the letter to:

**Responsible Official:** Teresa A. Eturaspe

**Position/Title:** SEPA/NEPA Coordinator, WDFW Regulatory Services Section

**Address:** 600 Capitol Way North, Olympia, WA 98501

You can also send your comments via email to [SEPAdesk@dfw.wa.gov](mailto:SEPAdesk@dfw.wa.gov), or via fax to (360) 902-2946.

If you have questions about this DNS or the details of the proposal, contact Teresa Eturaspe at the address, e-mail, or fax number above; you can also call her at (360) 902-2575.

**DATE OF ISSUE:** July 17, 2008

**SIGNATURE:**

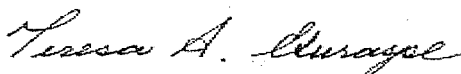

Footnotes

1. RCW 43.21C.030(2)(c)
2. WAC 197-11-340(2).

SEPA Log Number: 08 -056. dns

**Distribution of Environmental Document:**

Department of Ecology, Environmental Review Section, Olympia

Department of Natural Resources, SEPA Center, Olympia

U.S. Fish and Wildlife Service, Upper Columbia River Basin Field Office, Spokane

U.S. Army Corps of Engineers, Seattle

NOAA - Fisheries, Seattle

Kittitas County Planning Department, Ellensburg

State Parks and Recreation Commission, Olympia

Dept of Archaeology and Historic Preservation

Yakama Nation, Toppenish

Columbia River Inter-Tribal Fisheries Commission, Portland, OR

Department of Transportation, So. Central Region, Yakima

WDFW, Habitat Program, Region 3, Yakima

WDFW, Fish Program, Region 3, Yakima

WDFW, Wildlife Program, Region 3, Yakima



Washington  
Department of  
**FISH and  
WILDLIFE**

**State of Washington  
DEPARTMENT OF FISH AND WILDLIFE**

Mailing Address: 600 Capitol Way N, Olympia, Washington 98501-1091 - (360) 902-2200

**ENVIRONMENTAL CHECKLIST  
(WAC 197-11-960)**

**A. BACKGROUND**

1. **Name of proposed project, if applicable:** Yakima Canyon Access Site
2. **Name of Applicant:** Washington Department of Fish and Wildlife
3. **Address and phone number of applicant and contact person:**  
Washington Dept of Fish and Wildlife  
Capitol Programs & Engineering Division  
600 Capitol Way North  
Olympia, WA 98501-1091  
Contact Person: Marty Peoples  
Fish and Wildlife Biologist  
Telephone Number: (360) 902-8426  
Fax Number: (360) 902-8367  
E-Mail: peoplmdp@dfw.wa.gov
4. **Date checklist prepared:** July 15, 2008
5. **Agency requesting checklist:** Washington Department of Fish and Wildlife
6. **Proposed timing or schedule (including phasing, if applicable):**  
*Construction is scheduled to begin in September or October 2008.*
7. **Do you have any plans for future additions, expansion, or further activity related to or connected with this proposal? If yes, explain.**  
*No.*
8. **List any environmental information you know about that has been prepared, or will be prepared, directly related to this proposal:**  
*No other environmental information has been prepared.*
9. **Do you know whether applications are pending for governmental approvals of other proposals directly affecting the property covered by your proposal? If yes, explain.** *None pending.*
10. **List any government approvals or permits that will be needed for your proposal, if known.**  
*A Kittitas County Shoreline, WDFW Hydraulic Project Approval, and a Septic permit will be needed.*
11. **Give brief, complete description of your proposal, including the proposed uses and the size of the project and site. There are several questions later in this checklist that ask you to describe**



**certain aspects of your proposal. You do not need to repeat those answers on this page.**

*This project includes the improvement of a primitive access site in the Yakima River Canyon near Roza Dam. The specific components of this project are:*

1. *Pave the entrance to the access site to meet WSDOT guidelines.*
  2. *Install a vault toilet and a paved parking pad next to the toilet to provide ADA parking and accessibility.*
  3. *Grade and gravel access road and parking areas at this site. Install barrier rock to control access.*
  4. *Cut the top of the gravel bank at existing boat launch to attain a 15% grade.*
  5. *Convert an informal dirt road on this site into a paved ADA accessible interpretive trail. This trail will be 5 feet wide.*
  6. *Construct a 10' by 20' concrete wildlife viewing pad and an ADA accessible parking pad next to the viewing pad.*
  7. *Install 4 strand smooth wire fence at Highway Right-of-Way.*
- 12. Location of the proposal. Give sufficient information for a person to understand the precise location of your proposed project, including street address, if any, and section, township, and range, if known. If a proposal would occur over a range of area, provide the range or boundaries of the site(s). Provide a legal description, site plan, vicinity map, and topographic map, if reasonably available. While you should submit any plans required by the agency, you are not required to duplicate maps or detailed plans submitted with any permit applications related to this checklist.**

*The Yakima River Canyon Access Site is located on the west side of SR 821 at milepost 8. This is two miles north of Roza Dam and directly across from Roza Road intersection with SR 821. The project site is in Kittitas County, Section 21, Township 15 North, Range 19 East. The parcel number is 174133.*

**B. ENVIRONMENTAL ELEMENTS**

**1. Earth**

- a. **General description of the site (underline one):** flat, rolling, hilly, steep slopes, mountainous, other \_\_\_\_\_.
- b. **What is the steepest slope on the site (approximate percent slope)?** 10%.
- c. **What general types of soils are found on the site (for example, clay, sand, gravel, peat, muck)? If you know the classification of the agricultural soils, specify them and note any prime farmland.**

*The soil is classified as Weirman-Kayak-Zillah complex, which is mainly sandy, gravelly, loam.*

- d. **Are there surface indications or history of unstable soils in the immediate vicinity? If so, describe.** No.

- e. **Describe the purpose, type and approximate quantities of any filling or grading proposed. Indicate source of fill.**

*The dirt parking area will be graded and imported crushed aggregate will be placed on the parking area. There will be 138 cubic yards of asphalt for the pathway, entrance and parking pads. 620 cubic yards of gravel will be used for parking, roadways, and sub base.*

- f. **Could erosion occur as a result of clearing, construction or use? If so generally describe.**

*Not likely. There will be a minimum of new disturbed areas with all construction occurring within a surrounding graveled area.*

- g. **About what percent of the site will be covered with impervious surfaces after project construction (for example, asphalt or buildings)?**

*Approximately 4% of the site will be covered with new impervious surfaces, including asphalt, parking, pathway, view pad and gravel surfacing..*

- h. **Proposed measures to reduce or control erosion, or other impacts to the earth, if any:**

*Any potential erosion will be prevented using erosion control BMP's.*

**2. Air**

- a. **What type of emissions to the air would result from the proposal (i.e., dust automobile, odors, industrial wood smoke) during construction and when the project is completed? If any, generally describe and give approximate quantities if known.**

*Vehicle exhaust and dust from construction is expected. No long-term change in emissions is expected from the completed project.*

- b. **Are there any off-site sources of emissions or odor that may affect your proposal? If so, generally describe. No.**

- c. **Proposed measures to reduce or control emissions or other impacts to air, if any: None.**

**3. WATER**

**a. Surface**

- 1) **Is there any surface water body on or in the immediate vicinity of the site (including year-round and seasonal streams, saltwater, lakes ponds or wetlands)? If yes, describe type and provide names. If appropriate, state what stream or river it flows into.**

*The Yakima River is located immediately next to the project site. The Yakima River is a tributary of the Columbia River.*

- 2) **Will the project require any work over, in, or adjacent to (within 200 feet) the described waters? If yes, please describe and attach available plans.**

*This greater portion of this project will occur within 200 feet of Yakima River. The boat ramp bank cut will be performed during fall low flow periods and will be out of the water completely. The project description is listed in question 11 and the project plans are attached.*

- 3) Estimate the amount of fill and dredge material that would be placed in or removed from surface water or wetlands and indicate the area of the site that would be affected. Indicate the source of fill material.

*No material will be added to or removed from surface waters or wetlands.*

- 4) Will the proposal require surface water withdrawals or diversions? Give general description, purpose, and approximate quantities if known. *No.*

- 5) Does the proposal lie within a 100-year floodplain? If so, note location on the site plan. *Yes.*

- 6) Does the proposal involve any discharges of waste material to surface waters? If so, describe the type of waste and anticipated volume of discharge.

*No waste material will be discharged into surface waters.*

**b. Ground**

- 1) Will ground water be withdrawn, or will water be discharged to ground water? Give general description purpose, and approximate quantities, if known. *No.*

- 2) Describe waste material that will be discharged into the ground from septic tanks or other sources, if any (for example: Domestic sewage; industrial, containing the following chemicals. . . ; agricultural; etc.). Describe the general size of the system, the number of such systems, the number of houses to be served (if applicable), or the number of animals or humans the system(s) are expected to serve.

*No waste material will be discharged.*

**c. Water Runoff (including storm water):**

- 1) Describe the source of runoff (including storm water) and method of collection and disposal, if any (including quantities, if known). Where will this water flow? Will this water flow into other waters? If so, describe.

*Storm water will be infiltrated in grass filter strips located at the edge of the parking areas.*

- 2) Could waste materials enter ground or surface waters? If so, generally describe. *No.*

**d. Proposed measures to reduce or control surface, ground and runoff water impacts, if any:**

*None.*

**4. PLANTS**

**a. Check or underline types of vegetation found on the site:**

  x   deciduous tree: alder, willow, maple, aspen, cottonwood, other

     evergreen tree: fir, cedar, pine, other

  x   shrubs

grass

pasture

crop or grain

wet soil plants: cattail, buttercup, bulrush, skunk cabbage, other

water plants: waterlily, eelgrass, milfoil, other

other types of vegetation

b. What kind and amount of vegetation will be removed or altered? *None.*

c. List threatened and endangered species [of plants] known to be on or near the site.

*Populations of Basalt Daisy (Erigeron basalticus) and Hoover's Desert-parsley (Lomatium tuberosum) are located .75 miles south of the project site.*

d. Proposed landscaping, use of native plants, or other measures to preserve or enhance vegetation on the site, if any:

*No additional plantings will be made. Native shrubs and trees dominate the undeveloped areas already.*

## 5. ANIMALS

a. Underline any birds or animals, which have been observed on or near the site or are known to be on or near the site:

Birds: hawk, heron, eagle, songbirds, other:

Mammals: deer, bear, elk, beaver, other:

Fish: bass, salmon, trout, herring, shellfish, other:

b. List any threatened or endangered species known to be on or near the site.

*Middle Columbia River Steelhead, and Bull Trout are known to be near the site.*

c. Is the site part of a migration route? If so, explain.

*Anadromous salmon stocks pass through this portion of the river.*

d. Proposed measures to preserve and enhance wildlife, if any:

*To preserve fish stocks, WDFW will be time this project to be performed out of water. This should avoid any harmful impacts upon fish species.*

## 6. ENERGY AND NATURAL RESOURCES

a. What kinds of energy (electric, natural gas, oil, wood stove, solar) will be used to meet the completed project's energy needs? Describe whether it will be used for heating, manufacturing, etc. *N/A.*

- b. Would your project affect the potential use of solar energy by adjacent properties? If so, generally describe. *No.*
- c. What kinds of energy conservation features are included in the plans of this proposal? List other proposed measures to reduce or control energy impacts, if any: *None.*

**7. ENVIRONMENTAL HEALTH**

- a. Are there any environmental health hazards, including exposure to toxic chemicals, risk of fire and explosion, spill or hazardous waste that could occur as a result of this proposal. *No.*

- 1) Describe special emergency services that might be required. *None required.*
- 2) Proposed measures to reduce or control environmental health hazards, if any: *None.*

- b. Noise

- 1) What types of noise exist in the area which may affect your project (for example: traffic, equipment, operation, other)? *None.*
- 2) What types and levels of noise would be created by or associated with the project on a short-term or long-term basis (for example: traffic, construction, operation, other)? Indicate what hours noise would come from the site.

*Increased levels of noise during construction activities are expected from this project. Hours of increased noise levels will be 8 am to 7 pm. No change in noise level is expected from the completed project.*

- 3) Proposed measures to reduce or control noise impacts, if any: *None.*

**8. LAND AND SHORELINE USE**

- a. What is the current use of the site and adjacent properties?

*The current use is a primitive boat launch and parking area. This site is also used to access the river for recreational purposes including bird watching, swimming and fishing.*

- b. Has the site been used for agriculture? If so describe? *No.*

- c. Describe any structures on the site.

*This site has a parking area and informal boat launch but has no structures*

- d. Will any structures be demolished? If so what?

*No structures will be demolished.*

- e. What is the current zoning classification of the site?

*Forest and Range.*

- f. What is the current comprehensive plan designation of the site?

Rural.

- g. If applicable, what is the current shoreline master program designation of the site?**

Conservancy Shoreline Environment.

- h. Has any part of the site been classified as an "environmentally sensitive" area? If so, specify.**

*No.*

- i. Approximately how many people would reside or work in the completed project? *None.***

- j. Approximately how many people would the completed project displace? *None.***

- k. Proposed measures to avoid or reduce displacement impacts, if any: *None.***

- l. Proposed measures to ensure the proposal is compatible with existing and projected land uses and plans, if any:**

*No change in land use is proposed.*

**9. HOUSING**

- a. Approximately how many units would be provided, if any? Indicate whether high, middle, or low-income housing. *None.***

- b. Approximately how many units, if any, would be eliminated? Indicate whether high, middle, or low-income housing. *None.***

- c. Proposed measures to reduce or control housing impacts, if any: *None.***

**10. AESTHETICS**

- a. What is the tallest height of any proposed structure(s), not including antennas; what is the principal exterior building material(s) proposed?**

*An eight-foot tall vault toilet will be installed onsite. The principle building material will be concrete.*

- b. What views in the immediate vicinity would be altered or obstructed? *None.***

- c. Proposed measures to reduce or control aesthetic impacts, if any: *None.***

**11. LIGHT AND GLARE**

- a. What type of light or glare will the proposal produce? What time of day would it mainly occur?**

*No change will result in glare.*

- b. Could light or glare from the finished project be a safety hazard or interfere with views?**

*No.*

- c. What existing off-site sources of light or glare may affect your proposal? *None.***

- d. Proposed measures to reduce or control light and glare impacts, if any: *None.*

**12. RECREATION**

- a. What designated and informal recreational opportunities are in the immediate vicinity?

*Fishing, boating and swimming.*

- b. Would the proposed project displace any existing recreational uses? If so, describe.

*No.*

- c. Proposed measures to reduce or control impacts on recreation, including recreational opportunities to be provided by the project or applicant, if any: *None.*

**13. HISTORIC AND CULTURAL PRESERVATION**

- a. Are there any places or objects listed on, or proposed for, national, state, or local preservation registers known to be on or next to the site? If so, generally describe. *No.*

- b. Generally describe any landmarks or evidence of historic, archaeological, scientific, or cultural importance known to be on or next to the site. *None.*

- c. Proposed measures to reduce or control impacts, if any:

*Keep the project within the existing footprint.*

**14. TRANSPORTATION**

- a. Identify public streets and highways serving the site, and describe proposed access to the existing street system. Show on site plans, if any.

*SR 821 provides direct access to this site.*

- b. Is site currently served by public transit? If no, what is the approximate distance to the nearest transit stop?

*The site is not served by public transit. The nearest stop is approximately 5 miles away in Selah.*

- c. How many parking spaces would the completed project have? How many would the project eliminate?

*The completed project will not add or reduce parking spaces at the hatchery.*

- d. Will the proposal require any new roads or streets, or improvements to existing roads or streets, not including driveways? If so, generally describe (indicate whether public or private). *No.*

- e. Will the project use (or occur in the immediate vicinity of) water, rail, or air transportation? If so, generally describe. *No.*

- f. How many vehicular trips per day would be generated by the completed project? If known, indicate when peak volumes would occur.

*No additional vehicle trips are anticipated to result from this project.*

g. Proposed measures to reduce or control transportation impacts, if any: *None.*

**15. PUBLIC SERVICES**

a. Would the project result in an increased need for public services (for example: fire protection, police protection, health care, schools, other)? If so generally describe. *No.*

b. Proposed measures to reduce or control direct impacts on public services, if any: *None.*

**16. UTILITIES**

a. Underline utilities currently available at the site: Electricity, Natural Gas, Water, Refuse Service, Telephone, Sanitary Sewer, Septic System, Other.

b. Describe the utilities that are proposed for the project, the utility providing the service, and the general construction activities on the site or in the immediate vicinity, which might be needed.

*No additional utilities proposed.*

**C. SIGNATURE**

The above answers are true and complete to the best of my knowledge. I understand that the lead agency is relying on them to make its decision.

SIGNATURE: *Martin Angeles*      DATE SUBMITTED: *July 16, 2008*



